



Danbury Road, Loughton, IG10

BUTLER & STAG



**GUIDE PRICE £300,000 -
£325,000**

**Positioned in a quiet turning,
Danbury Lodge is set within
a niche development of only
four residents and offers
exceptional access to
Loughton's vibrant High
Street & central line station.**



Share of Freehold

- Share Of Freehold
- Semi Open Plan Lounge/Kitchen
- Security Entryphone System
- Two Bedroom First Floor Apartment
- Allocated Parking
- Close Proximity To Roding Valley Nature Reserve

Internally, the properties been immaculately presented throughout by its current owners and offers an abundance of living space which includes a bright & airy 13ft lounge/diner with views of the rear communal garden, fully fitted kitchen with plenty of storage cupboards, two double bedrooms and a family bathroom suite to complete.

Externally, the property comes with allocated parking and its own private communal garden for the four apartments to enjoy. Close by is Roding Valley Nature Reserve which is a vast area of open playing fields, ideal for families, dog walkers or fitness fanatics.

Loughton is known for its scenic views and being on the border of Epping Forest. It has excellent transport links into London from Loughton underground station, with the M11 and M25 being close by. With its highly regarded state and private schools within easy reach, its stylish, popular boutiques and abundance of eateries/bars makes it a desirable location.





Danbury Lodge,

Approx. 48.22 Sq. meters (519 Sq. feet)

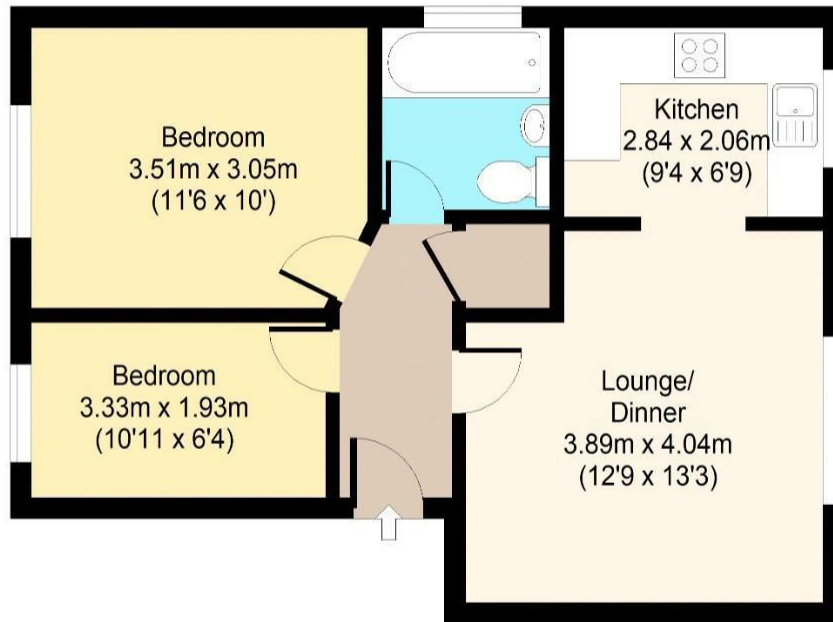

Total area: approx. 48.22 Sq. meters (519 Sq. feet)

For illustration purposes only - not to scale

www.lpaplus.com

IMPORTANT NOTICE - These particulars have been prepared in good faith and they are not intended to constitute part of an offer or contract. We have not performed a structural survey on this property and the services, appliances and specific fittings have not been tested. All photographs, measurements, floor plans and distances referred to are given as a guide and should not be relied upon.

BUTLER & STAG

☎ 01992 667666

🏠 4 Forest Drive, Theydon Bois, Essex, CM16 7EY

✉ theydon@butlerandstag.com

www.butlerandstag.uk